

ACREAGE AUCTION

SATURDAY, MAY 7, 2016 10:00 AM

SALE TO BE CONDUCTED AT THE PROPERTY

10814 - 48TH STREET, OTTUMWA, IOWA

2 miles south of Ottumwa on U.S. Hwy. 63, then East on 48th St. approx. 2 miles
Auction Signs Will Be Posted

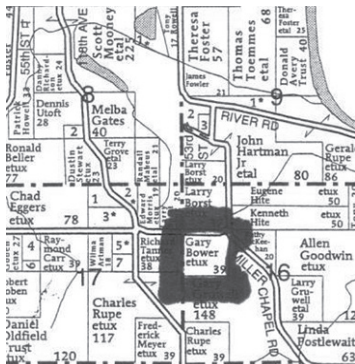

REAL ESTATE: This property consists of 40 acres, more or less, with large 2-bedroom manufactured home, with approx. 1,056 square feet of living space. This home has large living room, eat-in kitchen, 2 baths plus laundry room. Large front & rear decks, adjoining carport; large storage shed. Large front and rear decks, adjoining carport; large storage shed and storm shelter. This property has 2 rural water taps and is located in the Cardinal Community School District.

TERMS: 20% down day of sale, balance in cash upon delivery of a Warranty Deed, accompanied by Abstract of Title showing merchantable title. Real estate taxes will be pro-rated to possession date, possession given upon settlement.

REAL ESTATE WILL SELL AT 12:00 NOON

For further particulars or an appointment to inspect the property, please call the auction company: 641-682-5465.

FURNITURE & HOUSEHOLD ITEMS: Haier countertop refrigerator; Amana microwave; Near new oak 3-door glass-front lighted hutch; Brown microsuede rocker/recliner, like new; Microwave cart; Oak freestanding jewelry box; Like new wrought-iron glass-top rectangular patio table w/6 matching swivel rocker chairs; Lawn Glider; Several Norman Rockwell plates; Baby bed & changing table; School desk; Coaster wagon; 4-drawer chest of drawers; Large asst. of Coca-cola collectibles incl. lights, figurines, radio; Baskets; Asst. of decorator items incl. pictures, frames, Home Interior, wall hangings, asst. of wildlife figurines; VCR w/CD player; Asst. of pressed glassware incl. candy dishes, butter dish, creamer/sugar; Coffee table w/ matching end tables; Upholstered swivel office chair; (2) Rubbermaid deck boxes; Cabbage Patch dolls; Large Barbie doll; Canon printer; Records & tapes; 10-spd. mountain bike.

GUNS, GUN SAFE, HUNTING & FISHING SUPPLIES: New Remington Model 1100 12-ga; New Remington 1100 410; New Weatherby 12-ga, semi-auto, 2-3/4 & 3" shells; Remington 700 270 rifle; Browning Belgium 22 semi-auto; Winchester Model 97 16-ga; Stevens Crackshot 22 single-shot lever-action rifle; Remington Model 514 22 single-shot; Stevens 22 Trapper; JC Higgins bolt-action 16-ga. shotgun; Madison Corp 22 pistol; Antique 22 single-shot pistol; Large asst. of shells & ammo; Daisy pellet gun. **GUN PERMIT REQUIRED FOR THE PURCHASE OF ALL FIREARMS.** Large Cannon combination gun safe, like new, holds 36 guns; Minnkota elec. trolling motor; New turkey ground blind; Large asst. of fishing items incl. rods, reels, tackle & tackle-box; New full-size deer decoy, in box; Sears 12' v-bottom alum. boat w/trailer; Like new Kitchener #12 elec. meat grinder; Steel traps & live traps.

TRACTORS, ATV, LAWN MOWER & EQUIPMENT: 1973 Ford 7600 diesel tractor, WF, cab w/air, dual outlets, 3-pt, shows 3530 hours; Deutz D-6206 tractor, diesel, WF, 3-pt, like new, always shedded; Massey Ferguson 175 tractor, diesel, WF, 3-pt, multi-power, needs brakes; Polaris Ranger 500 2x4 ATV, 929 hours; Cub Cadet SLTX 1050 riding lawn mower, hydro, 50" deck; Vermeer 605H round baler, works good; Vermeer 605F, for parts; IH 1190 9' mower/conditioner; New Holland 56 rake; Ford 3-pt. PTO rake; Blair 6-bale self-unloading bumper-hitch hay trailer; (2) Hay racks & gears; Rhino heavy-duty 3-pt. 6' brush cutter; 3-pt. boom; 7' & 6' 3-pt. blades; Wagon running gear; Metal pickup stock rack; 3-pt. bale stabber; Set - 18.4x26 rear tractor chains; Posts; Wire; Gates; Cattle Panels; Big bale ring.

TOOLS: Like new 14" 16-spd. floor-mount drill press; Craftsman 110 port. air compressor w/33-gal. tank; Near new dual-action 220 welder; Small Campbell-Hausfield port. air compressor; Stihl 210 chain saw; Near new Generac gas-powered 3100 psi power washer; Manual tire changer; Large asst. of near new tools incl. Craftsman wrench sets, sockets sets, ratchet wrenches, 3/8" & 1/2" drive sockets, brand new Craftsman 1/2" drive socket set; New Craftsman 3/4" drive socket set; New Craftsman 1/2" elec. impact; Makita & Dewalt anglehead grinders; Jigsaws; (2) Craftsman base tool cabinets w/top boxes; New Otto welding helmet; Gas cans; Log roller; Drop cords; Levels; Craftsman 10" table saw; Handyman jack; Asst. of drills & drill bits; Bench grinder; Asst. of hoes, rakes, shovels, post jobbers; Log chains; Car ramps; New Milwaukee Sawzall; New Craftsman rotary die grinder; 6' & 12' fiberglass stepladders; 20' alum. extension ladder; Large asst. of hardware items incl. nuts, bolts, nails, oils, parts; Battery charger; Redline pressure pump w/tank; Garden sprayer; Tap & die set; 2-wheel dolly; Bar clamps; LP ventless wall heater; chicken brooder & nests.

CONIGNED FROM THE RONALD ROWE ESTATE - BULLDOZER, TRACTOR & EQUIPMENT: 1979 John Deere 750 bulldozer w/6-way front blade, power-shift, Serial #362971; Case IH 5220 Maxim tractor, cab, FWA, dual outlets, reverser, 16-spd. transmission, approx. 6400 hours; Kuhn GMD700 3-pt. disc mower; Kuhn SR10 10-wheel speed rake, hydraulic-fold, less than 2 years old, like new; New Holland 855 round baler, auto wrap, always shedded, like new; Near new Farm Star 3-pt. posthole digger; 3-pt. bale stabber; 3-pt. 7' rear blade; Long Wood dual-fuel woodburning furnace, holds 5' log. Also Consigned - John Deere 660 rake w/front dolly wheel; Shuler silage wagon; Heavy-duty 8-bale gooseneck hay trailer w/stabber.

AUCTIONEER'S NOTE: Be sure and attend this outstanding sale. 40 acres with a meticulously well-kept home plus large amount of machinery and tools. We have also included machinery from the Rowe Estate. Gary & Pat have decided to liquidate their farm and equipment and move to town. 10:00 AM - Household items; 11:00 AM - Guns & Tools; Noon - Real Estate; Tractors & Equipment at 1:30. See you there.

**TERMS: CASH/ GOOD CHECK
POSITIVE ID REQUIRED**

**MASTERCARD/VISA
DEBIT/CREDIT CARDS**

All property must be settled for before removal - All items sold as is where is
Not responsible in case of accidents.

Announcements made day of sale take precedence over any advertising.

GARY & PAT BOWER, OWNERS



Auctioneers:
Jim Kosman
Roger Clingan
Todd Carroll

AL MARTIN REAL ESTATE & AUCTION CO.
307 Church Street
Ottumwa, Iowa
641-682-5465

www.almartinauction.net

Find us on facebook at AIMartinRealEstateAuctionCo