

VIRTUAL ONLINE



Adair County, Missouri

Land Auction

Tuesday, September 6, 2022 at 10:00 AM

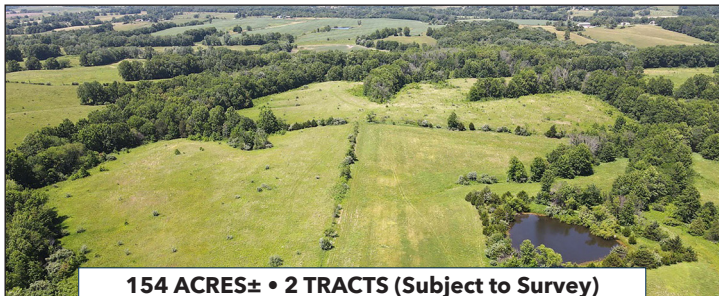

154 ACRES± • 2 TRACTS (Subject to Survey)

Land is located in Section 33, T63N•R14W, Clay Township, Adair County, MO. Tracts are located approximately 6 miles east of Kirksville, MO or approximately 18 miles west of Baring, MO.

FARM REPRESENTS PRODUCTIVE CROPLAND CURRENTLY IN IMPROVED PASTURELAND & HAY PRODUCTION WITH CRP (EXPIRING 2022) & BLACKTOP FRONTAGE.

**Garry L. Mathes | Barbara J. Miller | Anita L. Barker
Lisa Todd | Terry Beets | Dawn Fisher
Helen Rene Barker | Tami Western | Roger Lonberger**

Representing Attorney: David Rouner | Rouner Law Office LLC
400 N. Franklin Street | Kirksville, MO 63501 | (660) 665-7515

Title Work: Pickell Abstract Company
115 S. Franklin | Kirksville, MO 63501 | (660) 665-8324

Auction Managers: Bill Fretwell (660) 341-7735 & Jennifer Wood (217) 257-8812



SULLIVAN
AUCTIONEERS, LLC

(844) 847-2161

Sold@SullivanAuctioneers.com

License #444000107