

# LAND AUCTION

## Saturday, September 22 - 10:00 AM

**At the farm located from the East edge of Sigourney, IA at the 149/92 Jct go North 5 miles to 170th Street, go West 1/4 mile. Parcel A on the South side, Parcel B on the North side of the road. Located 2 miles from Belva Deer Lake.**

**PARCEL A** - 104.4 acres m/l timber pasture & timber. Good wildlife area; railroad right of way included. Taxes: \$1329 +/-; CSR: 36.1 +/-

**PARCEL B** - 18.5 acres m/l of timber. Good wildlife area; Taxes: \$318.00/year; CSR: 51.1

**TERMS:** 20% down day of sale. Balance in approximately 60 days. Possession on or before March 1, 2013. Subject to court approval.

Railroad right of way included with Parcel A.

Check our website for pictures and additional information.

**Howard Fry Heirs - Owners**  
**John Wehr, attorney for the heirs**

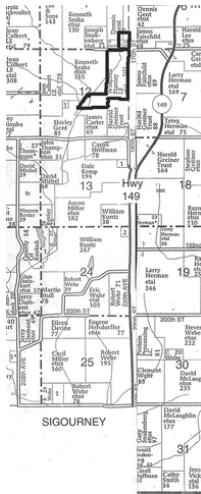

# HI-\$ AUCTION

**641-622-2015**  
[www.hidollar.com](http://www.hidollar.com)