

# Davis County, Iowa Land Auction

Sale will be held on site at 20170 on the south side of Highway #2, Bloomfield, Iowa on

**Saturday, November 8, 2014  
starting at 12:00 Noon**

## 77 Acres m/l Sells in 1 Tract

Highly productive tillable land. Land is located in Section 35 in Cleveland "W" Township south of Highway #2 at the Southwest edge of Bloomfield, Iowa.  
This farm is nearly all tillable with excellent location along hard surface road. This farm could be used for conventional or organic farming, or some type of housing or commercial development.  
The predominant soil types are Edina and Seymour for this farm. This farm has assigned "Corn Suitability Rating" of 57.2.  
This will be a good opportunity to buy a nice farm on hard surface road only a short distance from Bloomfield.

Terms: 20% down day at close of auction, balance due upon delivery court office deed showing marketable title.

Taxes: Will be prorated to date of possession.

Possession: Will be given at closing.

**69 big round bales of mixed grass hay, net wrapped; 14 big round bales of CRP, net wrapped. All baled with JD baler.**

**For more information contact Auctioneer Don Horn,  
641-208-0254 or 641-664-1385.**

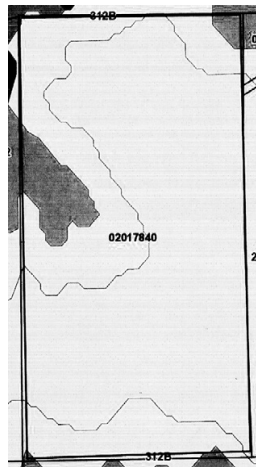

## Maxine McGrew Estate

20170 Highway #2, Bloomfield, Iowa 52537

John Martin • Bloomfield, Iowa • Attorney for Estate

Linda McGrew and Floyd McGrew • Co-Executors for Estate

**Terms: Cash or good check.  
\$35.00 returned check fee. Not  
responsible in case of accident**

The information in this sale brochure was obtained from the best reliable sources available to us. However, the Auctioneers or their employees will not be held liable should the above information be incorrect. Any announcement made day of sale will take precedence over any previous advertising.



**SALE CONDUCTED BY**

### Don Horn Auctioneering Service

209 East Jefferson, Bloomfield, IA  
Phone: 641-664-1385 • 641-722-3796 -Home  
• 641-208-0254 -Cell

**"We don't talk service, we give it."**

**Auctioneers:**

**Don Horn • Jerry Bish  
Rodney Lawson • Josh Williams**